

MIDDLEBURY INSTITUTE OF INTERNATIONAL STUDIES CAMPUS MAP

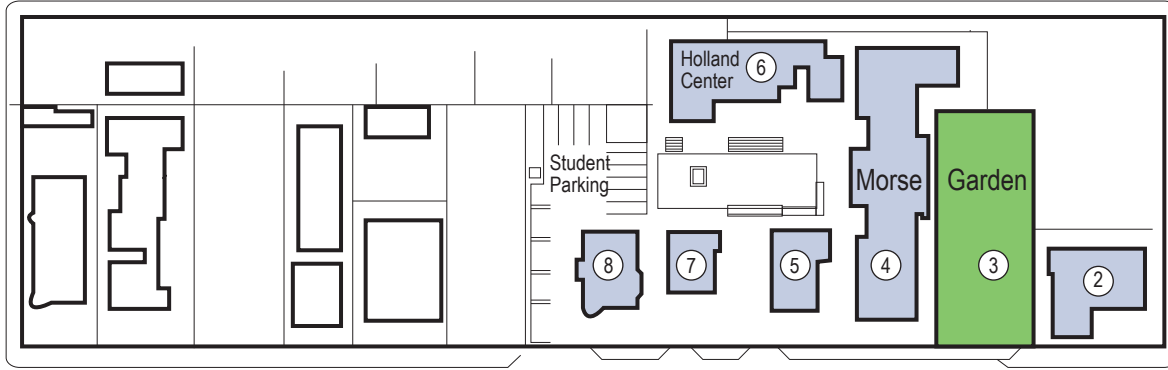

VAN BUREN STREET

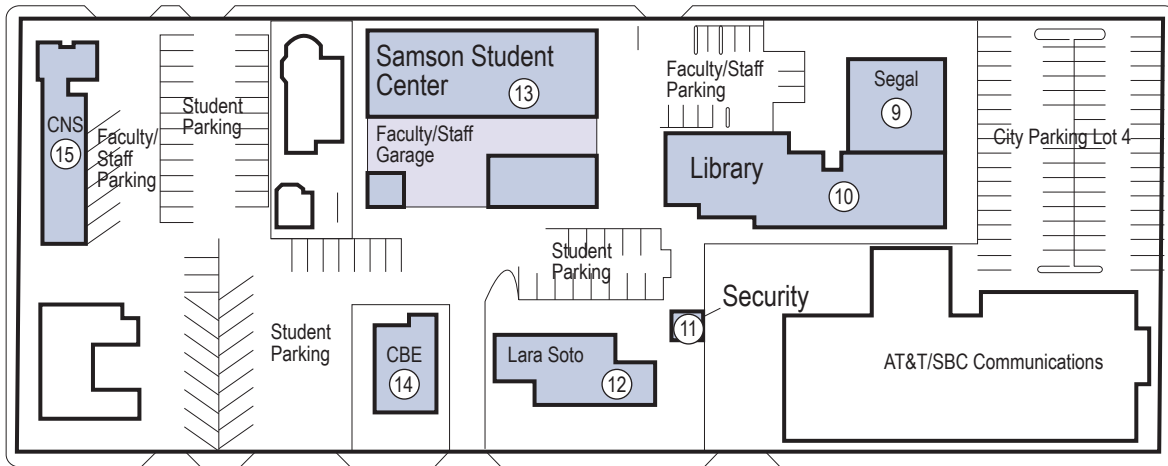

PIERCE STREET

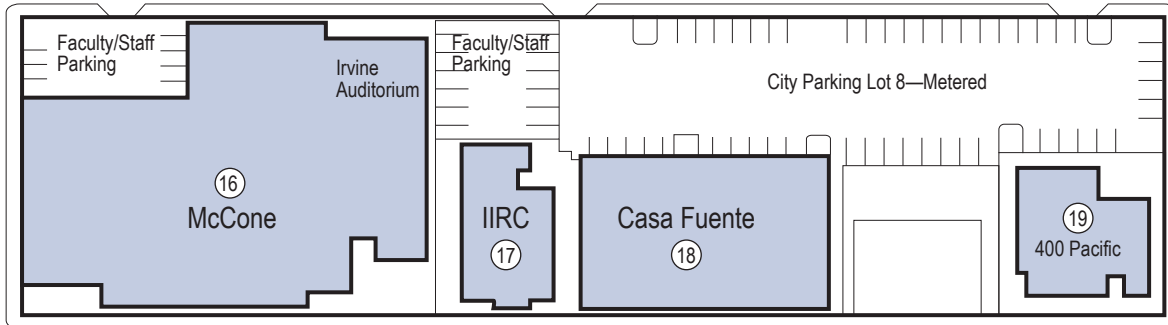

PACIFIC STREET

- 1 RODERICK HOUSE**, 530 West Franklin St.
Vice President's Residence
- 2 4-PLEX**, 400 Van Buren St.
Guest apartments and long-term rentals
- 3 OUR GREEN THUMB COMMUNITY GARDEN**,
424 Van Buren St.
- 4 MORSE BUILDING (MRSE)**, 426 Van Buren St.
Media Services, A & B Classrooms
- 5 STUDENT SERVICES**, 440 Van Buren St.
Student Services, Housing, International Services
- 6 HOLLAND CENTER**, 442½ Van Buren St.
Study Area, Courtyard
- 7 SIMONEAU HOUSE**, 456 Van Buren St.
Classroom
- 8 KINNOULL HOUSE (KNNL)**, 462 Van Buren St.
C Classrooms, ESL
- 9 SEGAL BUILDING**, 425 Van Buren St.
Vice President, Dean of Enroll, Career, & Student Svcs
- 10 WILLIAM TELL COLEMAN LIBRARY**, 425 Van Buren St.
Library, Fletcher-Jones Career Center
- 11 SECURITY OFFICE**, 460 Pierce St. (by Adobe)

- 12 LARA SOTO ADOBE**, 460 Pierce St.,
Faculty & Staff Lounge
- 13 SAMSON STUDENT CENTER**, 453 Van Buren St.
Dining, Media Room, Reading Room, Patio, Courtyard, Vending
- 14 CRAIG BUILDING (CRAG)**, 472 Pierce St.
Center for the Blue Economy, Classroom
- 15 CNS BUILDING (V499)**, 499 Van Buren St.
James Martin Center for Nonproliferation Studies, Classrooms
- 16 MCCONE BUILDING (MCCN)**, 499 Pierce St.
Irvine Auditorium, GSIPM, GSTILE, Boardroom,
Center for Advising & Career Services, Classrooms
- 17 IIRC BUILDING**, 464 Pacific St. Classroom, SL3
- 18 CASA FUENTE (CFNT)**, 449 Pierce St. & 450 Pacific St.
Computer Labs, Records, Business Office, Financial Aid,
Human Resources, Office & Campus Services, Information
Technology, Classrooms, SL1 & SL2
- 19 400 PACIFIC (400 PAC)**, Classrooms, Admissions Office
- 20 MCGOWAN BUILDING (MGWN)**, 411 Pacific St.
Alumni Relations, Language & Professional Programs,
MonTREP, META Lab, Advancement, Communications, DLC &
DLINQ, Wellness Center, Classrooms

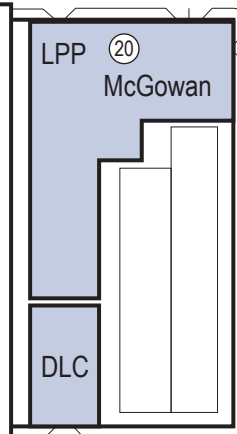

CALLE
PRINCIPAL

1

9

19

20